

EASYPACK 18 m²

Easy unpacking and assembly!

Flexibility

- ▶ EasyPack container house is a modular structure that can be built quickly and easily.
- ▶ It is lightweight, airtight, and shock-resistant. The structure allows for unlimited compounding in both the longitudinal and transverse directions. It is a cost-effective and flexible way to build a home.
- ▶ It is also highly insulated and water-proof, which means it will not let in any moisture. Expandable container house can also be combined together to form a larger structure if needed.

Structure

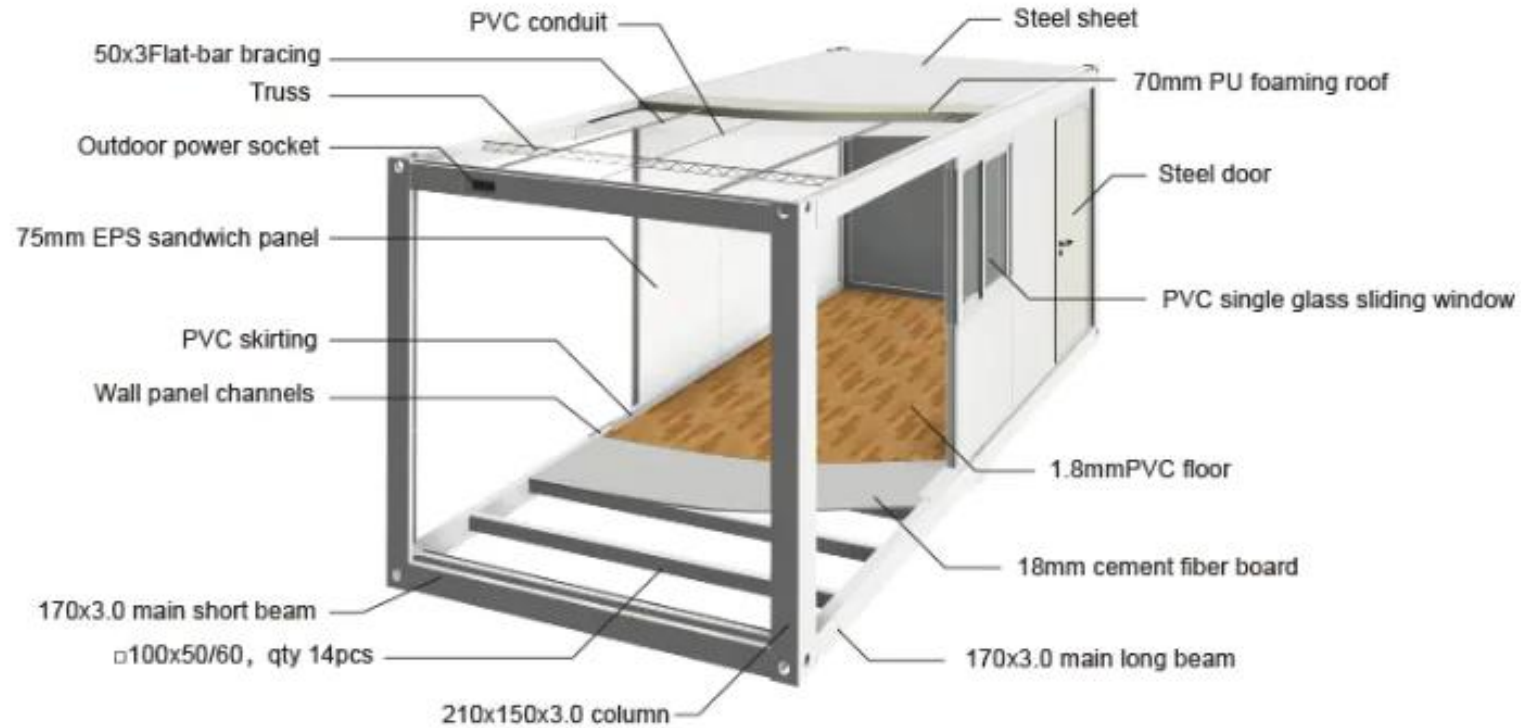

Plan

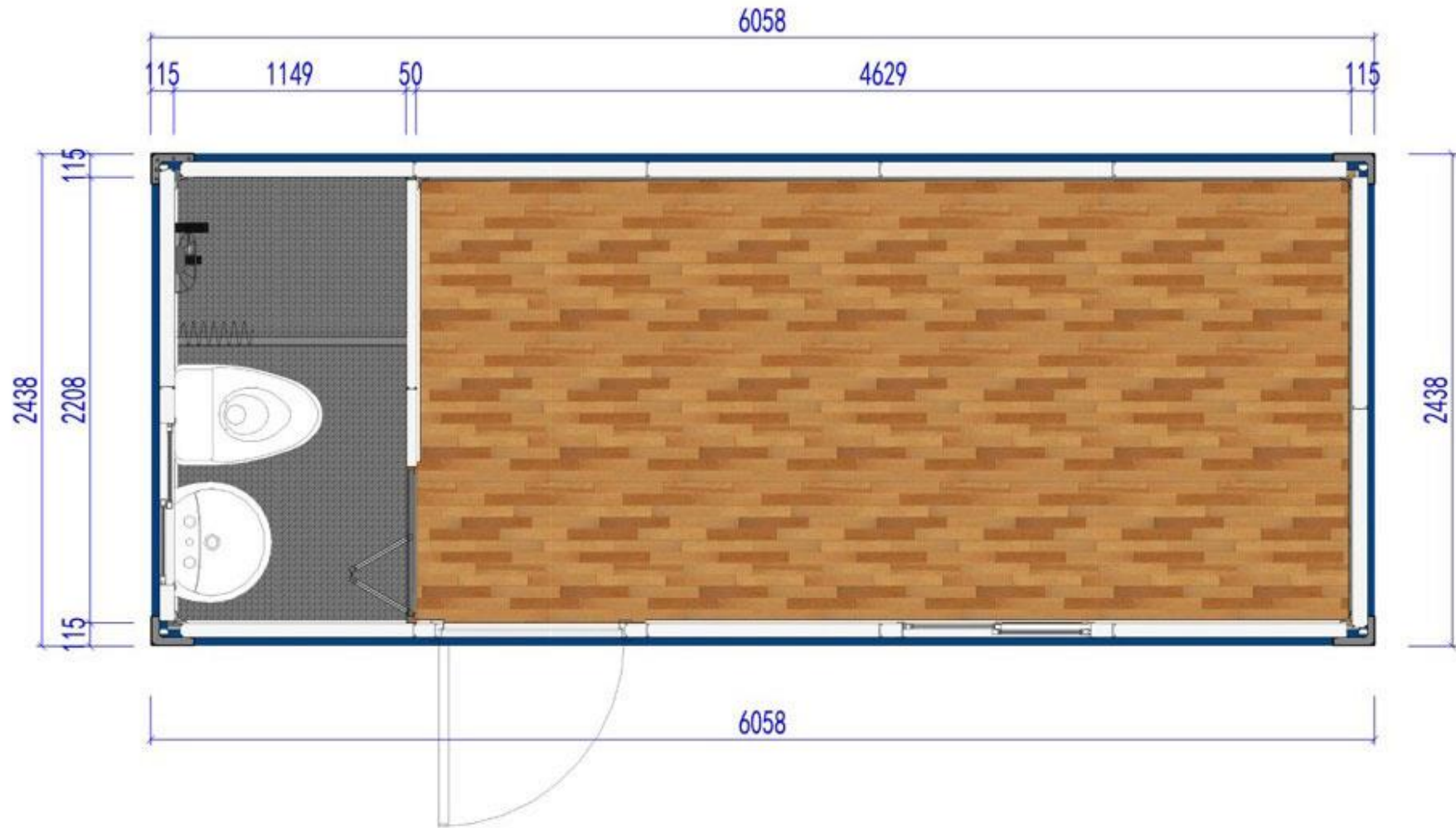

EasyPack Types:

With or without bathroom

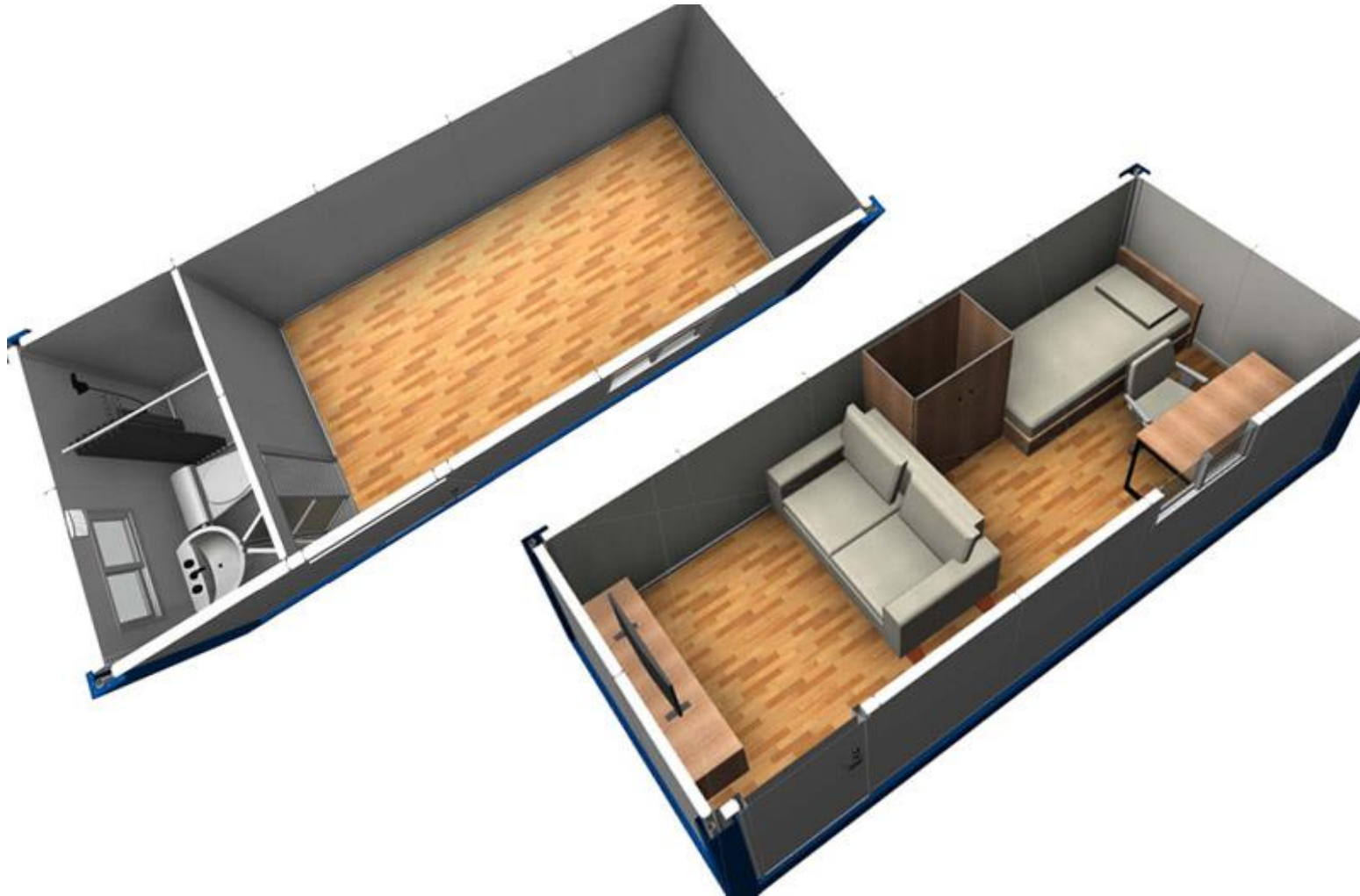

The roof and bottom of the house are manufactured in the factory and installed on site.



Waterproofing

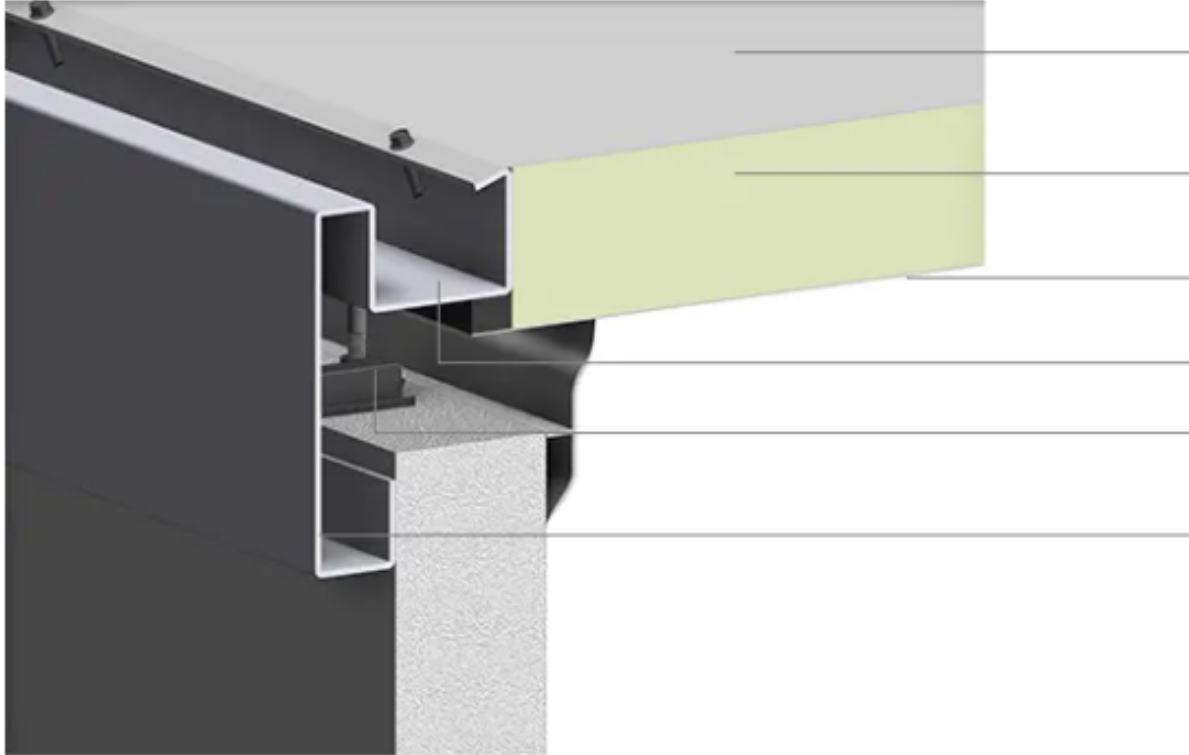

0.45mm colored steel sheet , color is optional , Aluminized zinc galvanized AZ50g/m²+PE baking finish15/5um

70mm PU foaming roof , PU density 45kg/m³

0.40mm colored steel sheet, color is milky white , Aluminized Zinc galvanized 50g/m²+PE baking finish15/5um.

Roof drainage channel, width is 71mm, column organized drainage

Wall panel clip

Container top main beam section height is 160mm , profile is 3.0mm,Q355

Permitted loading: 1.50KN/m²

K value(Thermal conductivity): 0.024W/mK

R value(Thermal Resistance): 2.92 m²K/W

Electricity Standard:

LED ceiling lamp: 2pcs x 30w LED ceiling lamps ,
L=1200mm

Switch: 1pc x single control switch (national standard rocker single control)

Socket: 2pcs x 10A sockets , 1pc x 32A 3-level outdoor waterproof inlet socket. Option: adding air conditioner socket

Distribution box: 1pc x 8-circuit power distribution box , built-in 1pc x 2P32A total circuit breaker (with leakage protection) , 1pc x 1P lighting circuit, 1pc x 1P socket circuit

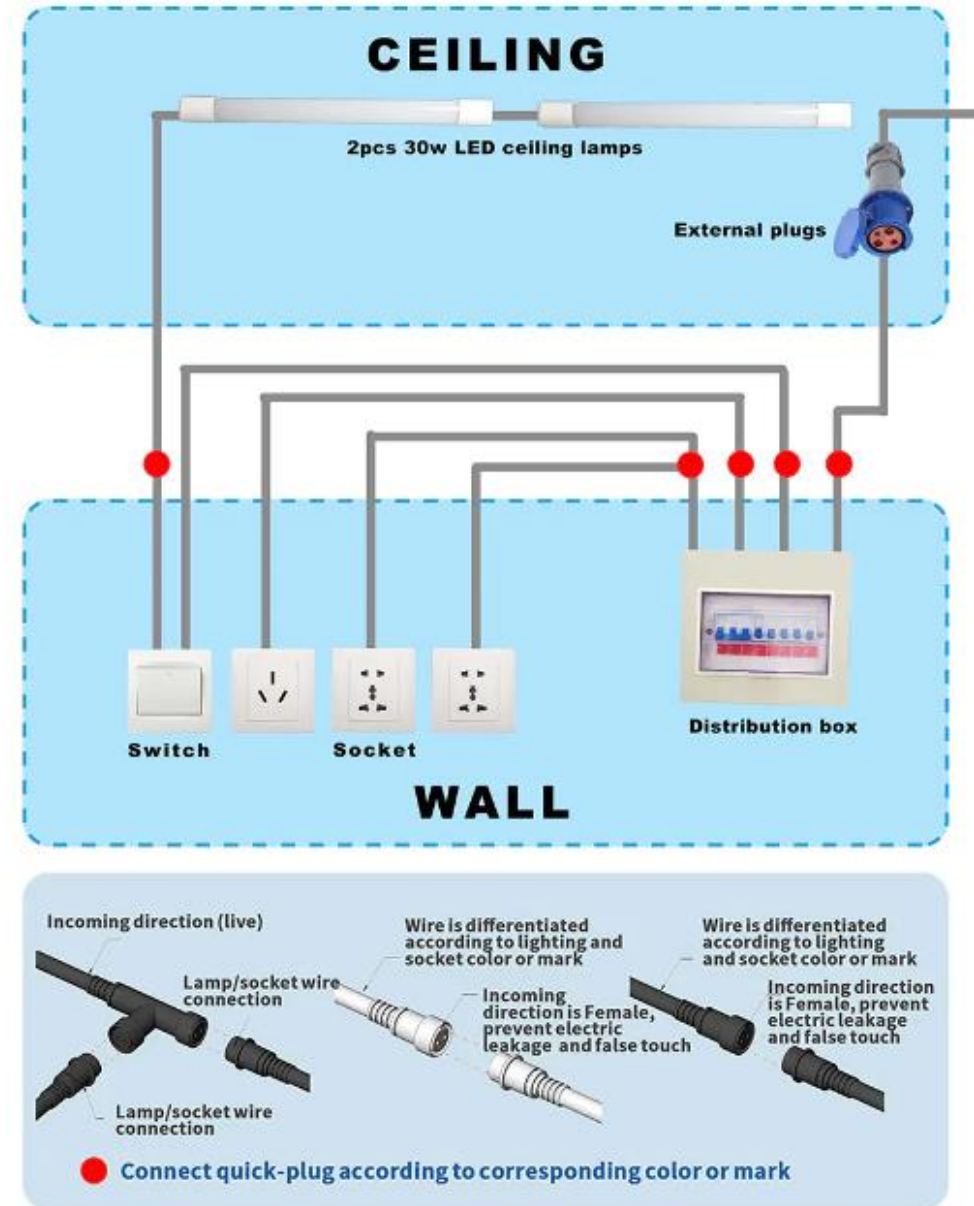

Specifications

Automatic robot welding :

All of our frames are made automatically by robots which keep the high precision and quick making speed .Our monthly delivery can reach 2000sets



Modulable

PTH container units are modular with the use of steel structural frame and thermal resistant material. This energy efficient product is commonly used in Construction camp site, Public building, Residential units and Special application areas.

PTH has upgraded the current version of container modules - all the components of the new version of container modules are made from standard and automatic production procedure. Installation procedure of the upgraded version containers are easy and reduces the on-site labor requirement.



Some examples





Options

Choose the colour, floor covering, insulation.

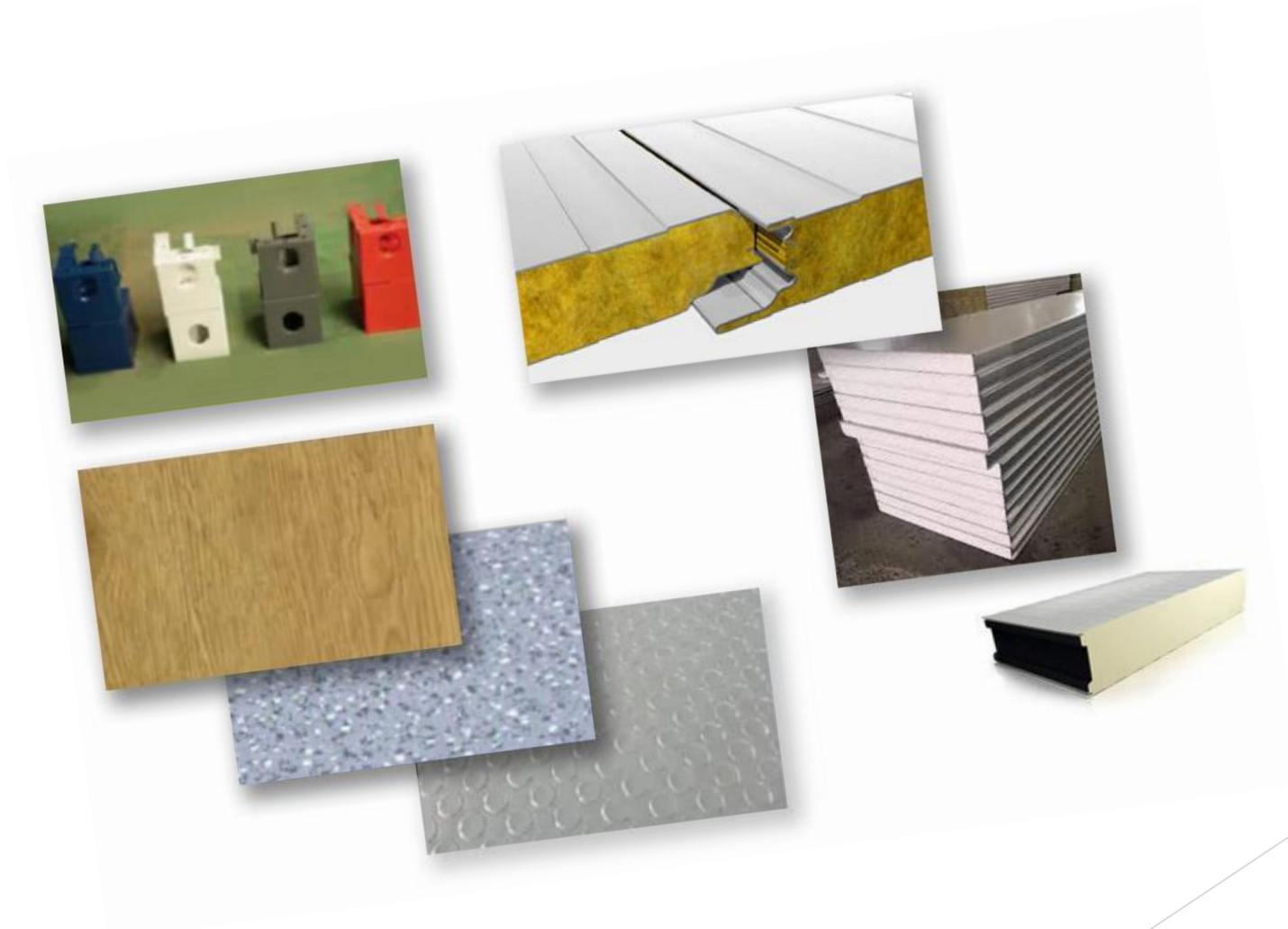

Conditionnement

OPTION :

Container size:6058mm*3025mm

*2591mm

Package method: detachable
components

Loading Qty: 8 units per 40ft HQ

